



112IM/212IM DOWN FILL BRACKET DF-IM

The DF-IM is a down fill bracket designed for use with the 212IM and 112IM loudspeaker enclosures. The bracket is intended to be mounted on a 212IM enclosure and a 112IM enclosure. In this configuration the 112IM should be mounted upside down and is then capable of being tilted thru a 45 degree angle in 5 degree steps.

DO NOT ATTEMPT TO SUSPEND ONE SYSTEMS PRODUCTS WITHOUT READING THE ONE SYSTEMS RIGGING MANUAL COMPLETELY.
(www.ONESYSTEMS.com).

DO NOT ATTEMPT TO SUSPEND ONE SYSTEMS PRODUCTS WITHOUT UNDERSTANDING EVERY ASPECT OF THIS MANUAL.

DO NOT ATTEMPT TO SUSPEND ONE SYSTEMS PRODUCTS WITHOUT UNDERSTANDING LOCAL AND NATIONAL CODES THAT APPLY TO OVERHEAD SUSPENSION OF PRODUCTS.

DO NOT ATTEMPT TO SUSPEND ONE SYSTEMS PRODUCTS UNLESS YOU ARE A PROFESSIONAL WITH A KNOWLEDGE OF LOCAL AND NATIONAL CODES RELATED TO SAFE SUSPENSION AND ARE EXPERIENCED IN SUSPENDING PRODUCTS OVERHEAD.

ALL ASSOCIATED RIGGING THE RESPONSIBILITY OF OTHERS.

ONE SYSTEMS® is not responsible for failures related to non-compliance with local and national codes and safe suspension practice.

Figure 1 is a representation of a “long throw” 212IM with an ET- 60/40 high frequency horn. A 112IM is mounted below and has an ET105/60 high frequency horn. In the example shown in Figure 1 the 212IM is functioning as a long throw system while the 112IM is in a “short throw” configuration.

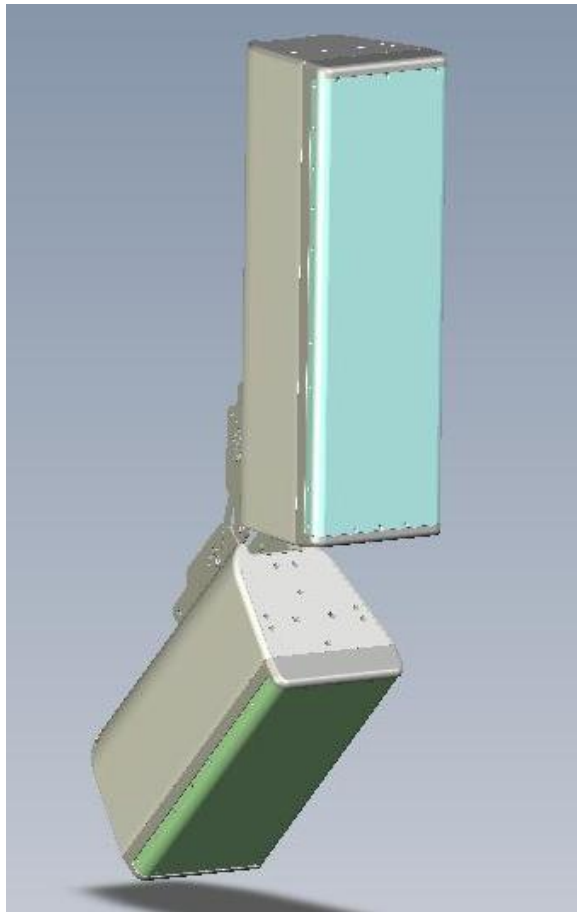

Figure 1 DF-IM down fill bracket
212IM and 112IM in long throw/short throw configuration

Figure 2 shows the DF-IM bracket assembly. This bracket assembly consists of the following parts:

- 2 ea. enclosure mounting brackets
- 1 ea. connecting bracket
- 1 ea. M12 hinge pin
- 1 ea. M12 stainless steel nylon insert flange nut
- 2 ea. M10 alignment pins
- 2 ea. M10 stainless steel nylon insert flange nuts

- 8 ea. M10 x 20 stainless steel bolts
- 8 ea. M10 internal tooth lock washers stainless steel

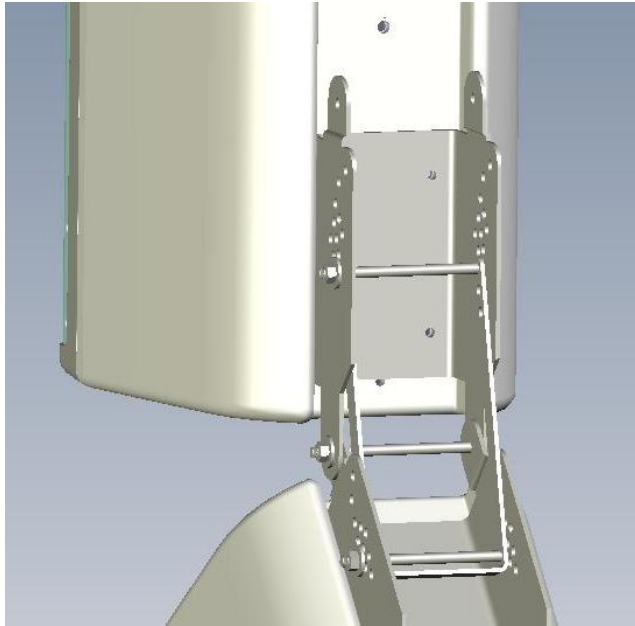
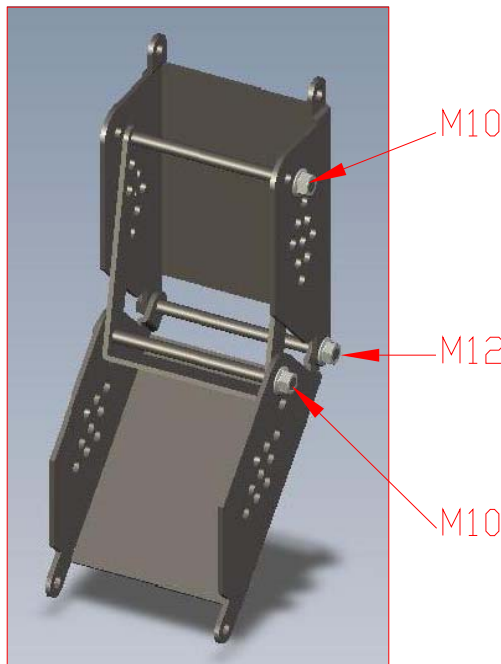

FIGURE 2

1. The two enclosure mounting brackets are identical and either may be mounted on the 212IM. The first bracket should be securely mounted to the 212IM enclosure and the internal tooth lock washers and M10 bolts should be fully tightened. Verify that all M10 bolts are secure and tight prior to proceeding.
2. The second enclosure mounting bracket should be mounted to the 112IM enclosure, with the enclosure positioned upside down in order to allow the 112IM bracket to mate with the identical bracket on the 212IM (see Figure 3). The M10 stainless steel bolts and internal tooth lock washers should be fully tightened.
3. The 212IM should now be rigged from the top as it will be flown and raised to a height that will allow the 112IM to be positioned and the two enclosure mounting brackets to be mated together.

WARNING: The top enclosure must be suspended in accordance with all local and national codes. Insure that the top enclosure is secure and rigged properly prior to lifting off the ground. Also double check all M10 bolts on both sections of the DF-IM

The M12 hinge pin should be inserted into the appropriate mounting holes using the M12 nylon insert nut. Do not substitute any parts.
This operation should require two people to perform safely.



DF-IM showing bolt locations

4. One of the M10 alignment pins now be used to mount the angle bracket to the lower enclosure mounting bracket (the 112IM).
The DF-IM is capable of aiming angles between 0 degrees and 45 degrees (down tilt) in 5 degree increments. The aiming data is shown below.

AIMING ANGLE	PIN LOCATIONS
0 degrees	0,3
5 degrees	5,1
10 degrees	10,1
15 degrees	15,1
20 degrees	20,2
25 degrees	25,3
30 degrees	30,2
35 degrees	35,1
40 degrees	40,1
45 degrees	45,1

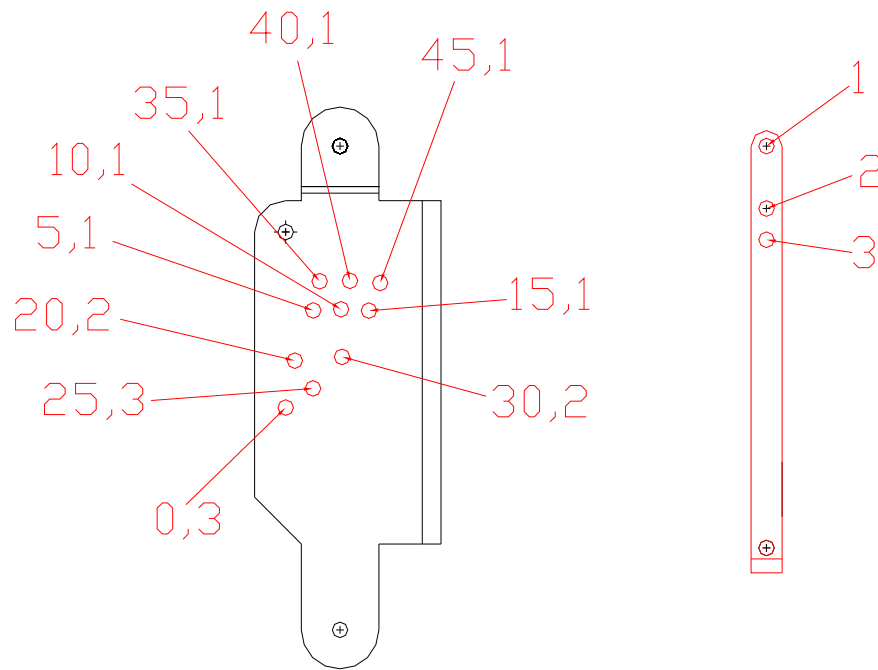

Aiming Locations for DF-IM

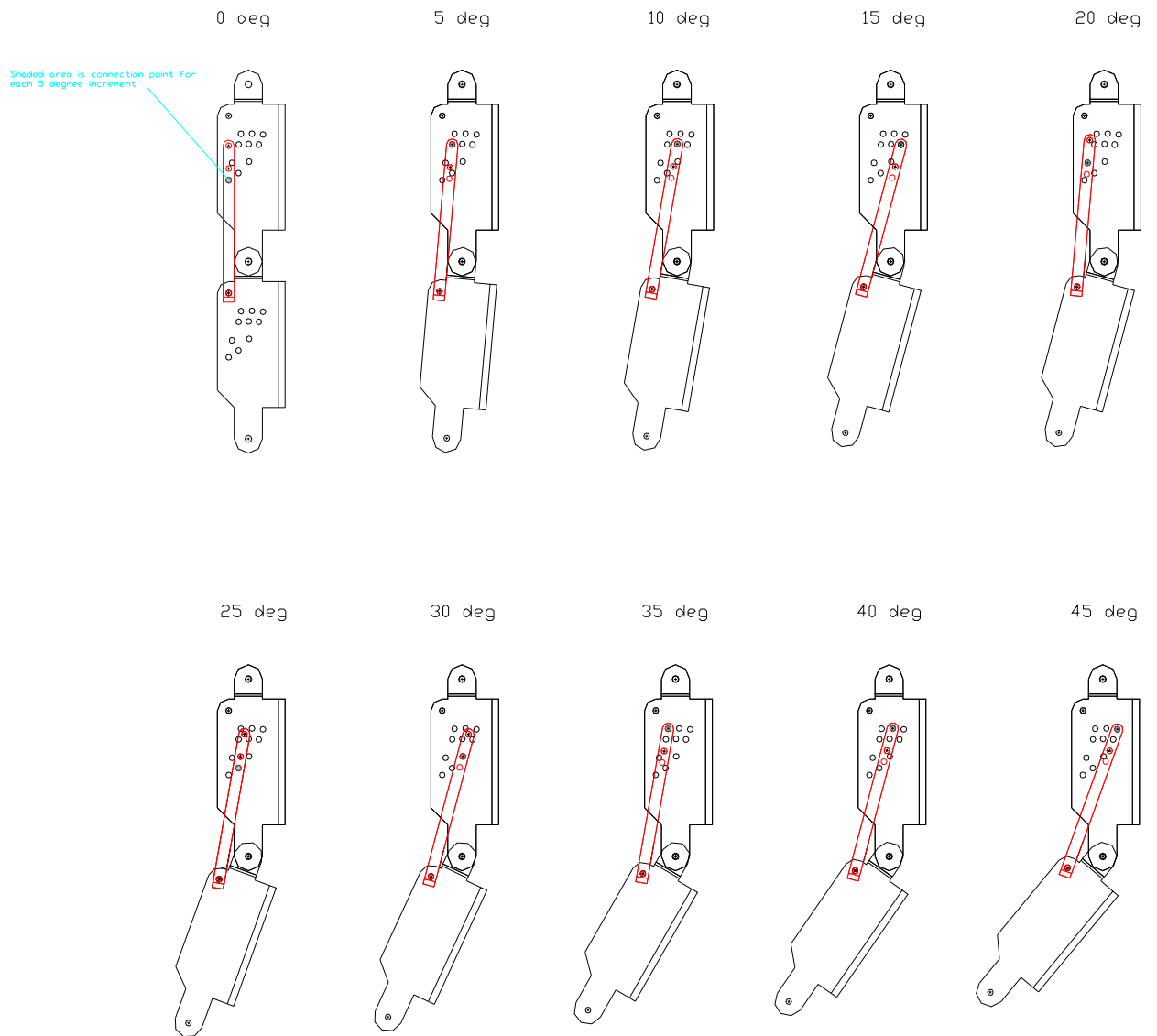

Bracket configurations for various aiming angles

5. The 112IM may now be lifted to achieve the desired down fill aiming angle. The second M10 alignment pin should now be used to set the desired mounting angle.

6. Tighten all bolts securely on both the 112IM and 212IM down fill bracket assembly. The two enclosure assembly may now be lifted to its desired height. All associated rigging the responsibility of others.



One Systems USA, Inc. * 6204 Gardendale Dr. * Nashville, TN 37215
One Systems Group Co. Ltd. * European Division * Mittelsmoorer Strasse 12 * 28879 Grassberg German
One Systems Global Co., Ltd. * 87/114 Modern Town 15th Floor * Sukhumvit 63, Ekkamai Soi 3, Klongtoey, Bangkok, 1010 Thailand